

CURRENT OWNER		TOPO.	UTILITIES	STRT./ROAD	LOCATION	CURRENT ASSESSMENT			
PERKINS, LESLIE & NANCY		4 Rolling	5 Well	1 Paved	7 Waterfront	Description	Code	Appraised Value	Assessed Value
33 LONDONDERRY ROAD			6 Septic			RESIDENTL	1013	108,600	108,600
WINDHAM, NH 03053		SUPPLEMENTAL DATA				RES LAND	1013	139,400	139,400
Additional Owners:						Other ID: 000086 000000 ACCT # 1 000882 ACCT # 2 000000			
GIS ID:		ASSOC PID#							

1510
SANBORNTON, NH

VISION

RECORD OF OWNERSHIP		BK-VOL/PAGE	SALE DATE	q/u	v/i	SALE PRICE	V.C.	PREVIOUS ASSESSMENTS (HISTORY)								
PERKINS, LESLIE & NANCY		2491/0494	04/28/2008	Q	I	285,000	00	Yr.	Code	Assessed Value	Yr.	Code	Assessed Value	Yr.	Code	Assessed Value
LEBEL, SUZANNE		1055/0001	06/07/1988	U	V		1N	2008	1013	109,000	2005	1013	125,600	2004	1013	117,100
								2008	1013	145,200	2005	1013	166,500	2004	1013	138,800
								Total:		254,200	Total:		292,100	Total:		255,900

EXEMPTIONS				OTHER ASSESSMENTS			
Year	Type	Description	Amount	Code	Description	Number	Amount
Total:							

This signature acknowledges a visit by a Data Collector or Assessor

ASSESSING NEIGHBORHOOD				
NBHD/ SUB	NBHD Name	Street Index Name	Tracing	Batch
A10/A	RES			

APPRAISED VALUE SUMMARY

Appraised Bldg. Value (Card)	106,700
Appraised XF (B) Value (Bldg)	1,900
Appraised OB (L) Value (Bldg)	0
Appraised Land Value (Bldg)	139,400
Special Land Value	0
Total Appraised Parcel Value	248,000
Valuation Method:	C
Exemptions	0
Adjustment:	0
Net Total Appraised Parcel Value	248,000

NOTES

WHITE
PHONECON W/OWNER
10/28/03
INT INFO

BUILDING PERMIT RECORD

Permit ID	Issue Date	Type	Description	Amount	Insp. Date	% Comp.	Date Comp.	Comments	Date	Type	IS	ID	Cd.	Purpose/Result
									10/28/2003			RM	07	Meas Info at Door
									08/13/2003			FA	02	Second Attempt

LAND LINE VALUATION SECTION

B #	Use Code	Use Description	Zone	D	Front	Depth	Units	Unit Price	I. Factor	S.A.	Acre Disc	C. Factor	ST. Idx	Adj.	Notes- Adj	Special Pricing	S Adj Fact	Adj. Unit Price	Land Value
1	1013	1 Fam Water	REC				0.47 AC	134,937.00	2.0347	9	1.0000	0.90	62	1.20	WEEDY		1.00	296,524.06	139,400
1	1013	1 Fam Water	REC				125.00 WF	0.00	1.0000	0	1.0000	1.00	62	1.20			.00	0.00	0

CONSTRUCTION DETAIL				CONSTRUCTION DETAIL (CONTINUED)			
Element	Cd.	Ch.	Description	Element	Cd.	Ch.	Description
Style	01		Ranch				
Model	01		Residential				
Grade	03		Average				
Stories	1		1 Story				
Occupancy	1						
Exterior Wall 1	25		Vinyl Siding				
Exterior Wall 2							
Roof Structure	03		Gable/Hip				
Roof Cover	03		Asph/F Gls/Cmp				
Interior Wall 1	07		K Pine/ Wood				
Interior Wall 2							
Interior Flr 1	14		Carpet				
Interior Flr 2							
Heat Fuel	02		Oil				
Heat Type	04		Forced Air-Duc				
AC Type	01		None				
Total Bedrooms	03		3 Bedrooms				
Total Bthrms	2						
Total Half Baths	0						
Total Xtra Fixtrs							
Total Rooms	6		6 Rooms				
Bath Style	02		Average				
Kitchen Style	02		Modern				
				MIXED USE			
				Code	Description		Percentage
				1013	1 Fam Water		100
				COST/MARKET VALUATION			
				Adj. Base Rate:			71.98
							134,171
				Net Other Adj:			10,000.00
				Replace Cost			144,171
				AYB			1962
				EYB			1987
				Dep Code			G
				Remodel Rating			
				Year Remodeled			
				Dep %			26
				Functional Obslnc			0
				External Obslnc			0
				Cost Trend Factor			1
				Condition			
				% Complete			
				Overall % Cond			74
				Apprais Val			106,700
				Dep % Ovr			0
				Dep Ovr Comment			
				Misc Imp Ovr			0
				Misc Imp Ovr Comment			
				Cost to Cure Ovr			0
				Cost to Cure Ovr Comment			

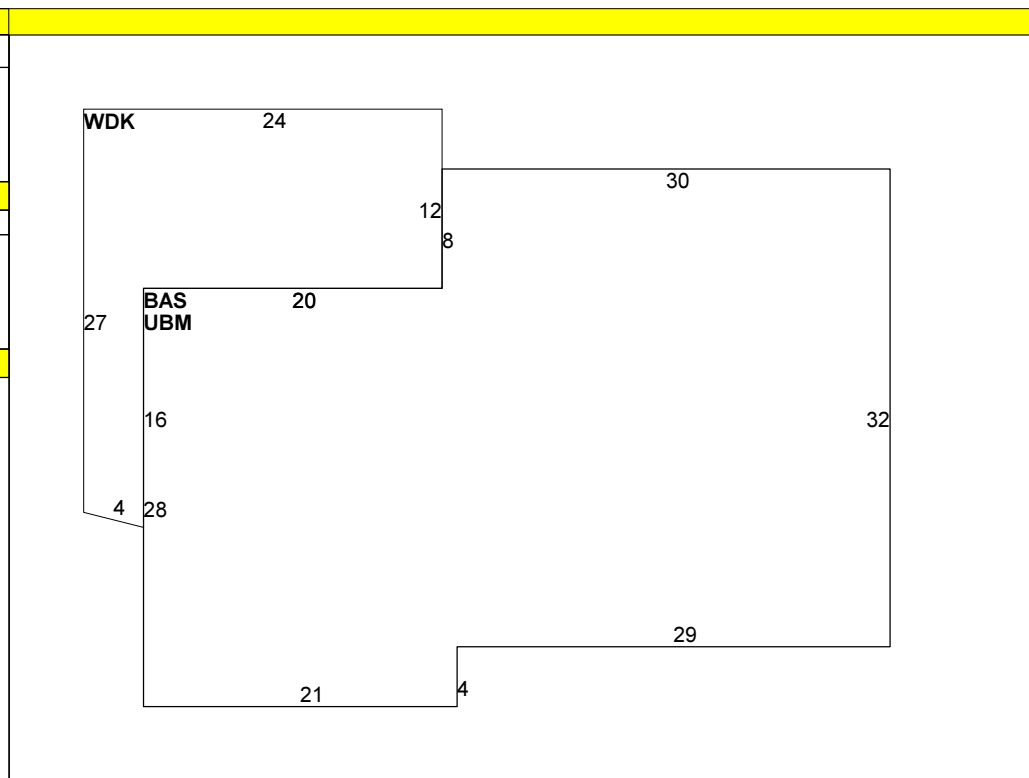

OB-OUTBUILDING & YARD ITEMS(L) / XF-BUILDING EXTRA FEATURES(B)

Code	Description	Sub	Sub Descript	L/B	Units	Unit Price	Yr	Gde	Dp Rt	Cnd	%Cnd	Apr Value
FPL1	FIREPLACE 1			B	1	2,500.00	1987		1		100	1,900

BUILDING SUB-AREA SUMMARY SECTION

Code	Description	Living Area	Gross Area	Eff. Area	Unit Cost	Undeprec. Value
BAS	First Floor	1,524	1,524	1,524	71.98	109,698
UBM	Basement Unfinished	0	1,524	305	14.41	21,954
WDK	Deck Wood	0	350	35	7.20	2,519

Ttl. Gross Liv/Lease Area:		1,524	3,398	1,864		144,171
-----------------------------------	--	-------	-------	-------	--	---------

