

| CURRENT OWNER | | TOPO. | UTILITIES | STRT./ROAD | LOCATION | CURRENT ASSESSMENT | | | |
|-----------------------------|--|------------|-----------|------------|----------|-----------------------|------|-----------------|----------------|
| THIBAUT, ALBERT AND SUSANNE | | 4 Rolling | 5 Well | 3 Unpaved | 3 Rural | Description | Code | Appraised Value | Assessed Value |
| 2 WELLS ROAD | | | 6 Septic | | | RESIDENTL | 1010 | 156,900 | 156,900 |
| SANBORNTON, NH 03269 | | | | | | RES LAND | 1010 | 47,900 | 47,900 |
| Additional Owners: | | | | | | RESIDENTL | 1010 | 12,200 | 12,200 |
| SUPPLEMENTAL DATA | | | | | | CURR USE | 6000 | 12,600 | 1,531 |
| | | | | | | CURR USE | 7000 | 22,000 | 1,974 |
| Other ID: 001260 | | | | | | | | | |
| ACCT # 1 008072 | | | | | | | | | |
| ACCT # 2 000000 | | | | | | | | | |
| GIS ID: | | ASSOC PID# | | | | Total 251,600 220,505 | | | |

1510
SANBORNTON, NH

VISION

| RECORD OF OWNERSHIP | BK-VOL/PAGE | SALE DATE | q/u | v/i | SALE PRICE | V.C. | PREVIOUS ASSESSMENTS (HISTORY) | | | | | | | | |
|-----------------------------|-------------|------------|-----|-----|------------|------|--------------------------------|------|----------------|--------|------|----------------|--------|------|----------------|
| THIBAUT, ALBERT AND SUSANNE | 0112/0431 | 05/18/1992 | U | V | | 1N | Yr. | Code | Assessed Value | Yr. | Code | Assessed Value | Yr. | Code | Assessed Value |
| | | | | | | | 2008 | 1010 | 156,900 | 2005 | 1010 | 174,600 | 2004 | 1010 | 166,500 |
| | | | | | | | 2008 | 1010 | 73,700 | 2005 | 1010 | 42,900 | 2004 | 1010 | 30,000 |
| | | | | | | | 2008 | 1010 | 8,200 | 2005 | 1010 | 8,200 | 2004 | 1010 | 8,200 |
| | | | | | | | 2008 | 6000 | 1,432 | 2005 | 6000 | 1,602 | 2004 | 6000 | 1,600 |
| | | | | | | | 2008 | 7000 | 1,984 | 2005 | 7000 | 2,219 | 2004 | 7000 | 1,764 |
| | | | | | | | Total: | | 242,216 | Total: | | 229,521 | Total: | | 208,064 |

| EXEMPTIONS | | | | OTHER ASSESSMENTS | | | |
|------------|------|--------------------|--------|-------------------|-------------|--------|--------|
| Year | Type | Description | Amount | Code | Description | Number | Amount |
| 2005 | VET1 | SEVICEMAN'S CREDIT | 500.00 | | | | |
| Total: | | | 500.00 | | | | |

This signature acknowledges a visit by a Data Collector or Assessor

| ASSESSING NEIGHBORHOOD | | | |
|------------------------|-----------|-------------------|-------|
| NBHD/ SUB | NBHD Name | Street Index Name | Batch |
| A10/A | RES | | |

APPRAISED VALUE SUMMARY

| | |
|---|----------------|
| Appraised Bldg. Value (Card) | 152,800 |
| Appraised XF (B) Value (Bldg) | 4,100 |
| Appraised OB (L) Value (Bldg) | 12,200 |
| Appraised Land Value (Bldg) | 47,900 |
| Special Land Value | 34,600 |
| Total Appraised Parcel Value | 251,600 |
| Valuation Method: | C |
| Exemptions | 500 |
| Adjustment: | 0 |
| Net Total Appraised Parcel Value | 251,100 |

NOTES
 BK/PG IN TO CU: 883/474
 15: ADJ OB/SKTCH
 INCLUDES SUB. OF 16.041
 16.041.001; .003; .004
 RED IA
 OB3 ATTACHED TO FGR
 EST FF FROM MAP

| BUILDING PERMIT RECORD | | | | | | | | | | VISIT/ CHANGE HISTORY | | | | |
|------------------------|------------|------|-------------|--------|------------|---------|------------|----------------------|------------|-----------------------|----|----|-----|----------------|
| Permit ID | Issue Date | Type | Description | Amount | Insp. Date | % Comp. | Date Comp. | Comments | Date | Type | IS | ID | Cd. | Purpose/Result |
| 2769 | 05/09/2007 | AC | Accessory | 0 | 04/07/2008 | 100 | 04/07/2008 | 64 SF DECK ADD ON TO | 03/26/2015 | | | CC | 56 | Field Review |
| 2589 | 06/29/2005 | AD | Addition | 0 | | 100 | 08/05/2006 | RE-ROOF BARN, ADD | 04/07/2008 | | | BP | 00 | Measur Listed |
| | | | | | | | | | 08/12/2006 | | | TO | 00 | Measur Listed |
| | | | | | | | | | 12/12/2003 | | | DG | 41 | Hearing Change |
| | | | | | | | | | 05/27/2003 | | | DG | 00 | Measur Listed |

LAND LINE VALUATION SECTION

| B # | Use Code | Use Description | Zone | D | Front | Depth | Units | Unit Price | I. | S.A. | Acre Disc | C. | ST. | Idx | Adj. | Notes- Adj | Special Pricing | | S Adj Fact | Adj. Unit Price | Land Value |
|-----|----------|-----------------|------|---|-------|-------|-------|------------|-----------|--------|-----------|--------|------|-----|------|------------|-----------------|-----------|------------|-----------------|------------|
| | | | | | | | | | | | | | | | | | Spec Use | Spec Calc | | | |
| 1 | 1010 | 1 Family | GA | | 1300 | | 1.00 | AC | 74,965.00 | 1.0000 | 5 | 1.0000 | 0.95 | A10 | 0.65 | WET | | | 1.00 | 46,290.89 | 46,300 |
| 1 | 1010 | 1 Family | GA | | | | 1.02 | AC | 5,500.00 | 1.0000 | 0 | 0.8800 | 0.50 | A10 | 0.65 | TOPO | | | 1.00 | 1,573.00 | 1,600 |
| 1 | 6000 | Farm Land | GA | | | | 8.00 | AC | 5,500.00 | 1.0000 | 0 | 0.8800 | 0.50 | A10 | 0.65 | TOPO | CU | 191.39 | 1.00 | 1,573.00 | 12,600 |
| 1 | 7000 | WPine | GA | | | | 14.00 | AC | 5,500.00 | 1.0000 | 0 | 0.8800 | 0.50 | A10 | 0.65 | | CU | 141.01 | 1.00 | 1,573.00 | 22,000 |

| CONSTRUCTION DETAIL | | | | CONSTRUCTION DETAIL (CONTINUED) | | | |
|---------------------|------|-----|---------------|---------------------------------|-----|-----|-------------|
| Element | Cd. | Ch. | Description | Element | Cd. | Ch. | Description |
| Style | 04 | | Cape Cod | | | | |
| Model | 01 | | Residential | | | | |
| Grade | 04 | | Average +10 | | | | |
| Stories | 1.75 | | 1 3/4 Stories | | | | |
| Occupancy | 1 | | | | | | |
| Exterior Wall 1 | 25 | | Vinyl Siding | | | | |
| Exterior Wall 2 | | | | | | | |
| Roof Structure | 03 | | Gable/Hip | | | | |
| Roof Cover | 01 | | Metal/Tin | | | | |
| Interior Wall 1 | 05 | | Drywall/Sheet | | | | |
| Interior Wall 2 | | | | | | | |
| Interior Flr 1 | 14 | | Carpet | | | | |
| Interior Flr 2 | | | | | | | |
| Heat Fuel | 02 | | Oil | | | | |
| Heat Type | 05 | | Hot Water | | | | |
| AC Type | 01 | | None | | | | |
| Total Bedrooms | 04 | | 4 Bedrooms | | | | |
| Total Bthrms | 2 | | | | | | |
| Total Half Baths | 0 | | | | | | |
| Total Xtra Fixtrs | | | | | | | |
| Total Rooms | 6 | | 6 Rooms | | | | |
| Bath Style | 02 | | Average | | | | |
| Kitchen Style | 02 | | Modern | | | | |
| | | | | Adj. Base Rate: | | | 66.90 |
| | | | | Net Other Adj: | | | 173,142 |
| | | | | Replace Cost | | | 11,000.00 |
| | | | | AYB | | | 184,142 |
| | | | | EYB | | | 1992 |
| | | | | Dep Code | | | 1996 |
| | | | | Remodel Rating | | | A |
| | | | | Year Remodeled | | | |
| | | | | Dep % | | | 17 |
| | | | | Functional Obslnc | | | 0 |
| | | | | External Obslnc | | | 0 |
| | | | | Cost Trend Factor | | | 1 |
| | | | | Condition | | | |
| | | | | % Complete | | | |
| | | | | Overall % Cond | | | 83 |
| | | | | Apprais Val | | | 152,800 |
| | | | | Dep % Ovr | | | 0 |
| | | | | Dep Ovr Comment | | | |
| | | | | Misc Imp Ovr | | | 0 |
| | | | | Misc Imp Ovr Comment | | | |
| | | | | Cost to Cure Ovr | | | 0 |
| | | | | Cost to Cure Ovr Comment | | | |

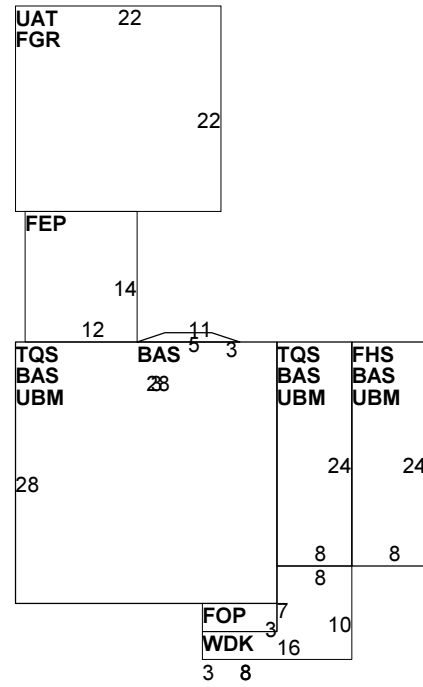

| OB-OUTBUILDING & YARD ITEMS(L) / XF-BUILDING EXTRA FEATURES(B) | | | | | | | | | | | | |
|--|--------------|-----|--------------|-----|-------|------------|------|-----|-------|-----|------|-----------|
| Code | Description | Sub | Sub Descript | L/B | Units | Unit Price | Yr | Gde | Dp Rt | Cnd | %Cnd | Apr Value |
| BRN3 | BRN 1 STY LO | | | L | 600 | 22.00 | 2003 | | 0 | | 50 | 6,600 |
| LNT | LEAN TO | | | L | 200 | 7.00 | 2003 | | 0 | | 30 | 400 |
| FCP | CARPORT | | | L | 220 | 11.00 | 2003 | | 0 | | 50 | 1,200 |
| DP3 | DRIVE LARGE | | | L | 1 | 4,000.00 | 2013 | | 0 | | 100 | 4,000 |
| FPL3 | 2 STORY CHIM | | | B | 1 | 4,000.00 | 1996 | | 1 | | 100 | 3,300 |
| HRT | HEARTH | | | B | 1 | 1,000.00 | 1996 | | 1 | | 100 | 800 |

| BUILDING SUB-AREA SUMMARY SECTION | | | | | | |
|-----------------------------------|-------------------------|--------------|--------------|--------------|-----------|-----------------|
| Code | Description | Living Area | Gross Area | Eff. Area | Unit Cost | Undeprec. Value |
| BAS | First Floor | 1,176 | 1,176 | 1,176 | 66.90 | 78,677 |
| FEP | Porch Enclosed Finished | 0 | 168 | 118 | 46.99 | 7,894 |
| FGR | Garage Finished | 0 | 484 | 169 | 23.36 | 11,306 |
| FHS | Half Story Finished | 96 | 192 | 96 | 33.45 | 6,423 |
| FOP | Porch Open Finished | 0 | 24 | 5 | 13.94 | 335 |
| TQS | Three Quarter Story | 732 | 976 | 732 | 50.18 | 48,972 |
| UAT | Attic Unfinished | 0 | 484 | 48 | 6.63 | 3,211 |
| UBM | Basement Unfinished | 0 | 1,168 | 234 | 13.40 | 15,655 |
| WDK | Deck Wood | 0 | 104 | 10 | 6.43 | 669 |
| Ttl. Gross Liv/Lease Area: | | 2,004 | 4,776 | 2,588 | | 184,142 |

